

# CI Series Flood Spray Nozzles - Flat Tip Type

CI

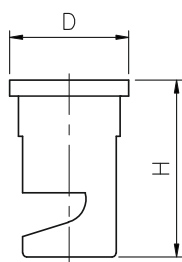

Wide angle jet with sharply defined spray pattern

**Application :**

Control of foam in effluent tanks, sewage treatment plants, coal treatment plants, coal washing cooling washing and rinsing operations where high jet impact flow is required.

90° SPRAY ANGLE	MODEL NO.	ORIFICE SIZE (mm)	FLOW CAPACITY IN LPM AT DIFFERENT PRESSURE							G/A DIMENSION. MM		
			SPRAY ANGLE	PRESSURE [BAR]							H	D
				0.5	1.0	2.0	3.0	5.0	7.0	10.0	22	14.8
	CI16.050	0.8	90°	0.25	0.35	0.50	0.61	0.79	0.94	1.12	Weight (Metals) = 32 gms. Approx	
	CI16.075	1.0		0.37	0.53	0.75	0.92	1.19	1.40	1.68		
	CI16.100	1.2		0.50	0.71	1.00	1.22	1.58	1.87	2.24		
	CI16.150	1.5		0.75	1.06	1.50	1.84	2.37	2.81	3.35		
	CI16.175	1.6		0.87	1.24	1.75	2.14	2.77	3.27	3.91		
	CI16.200	1.7		1.00	1.41	2.00	2.45	3.16	3.74	4.47		
	CI16.250	1.9		1.25	1.77	2.50	3.06	3.95	4.68	5.59		
	CI16.300	2.1		1.50	2.12	3.00	3.67	4.74	5.61	6.71		
	CI16.350	2.3		1.75	2.47	3.50	4.29	5.53	6.55	7.83		
	CI16.400	2.4		2.00	2.83	4.00	4.90	6.32	7.48	8.94		
	CI16.475	2.7		2.37	3.36	4.75	5.82	7.51	8.89	10.62		
	CI16.650	3.1		3.25	4.60	6.50	7.96	10.28	12.16	14.53		
	CI16.800	3.5		4.00	5.66	8.00	9.80	12.65	14.97	17.89		
	CI26.100	3.9		5.00	7.07	10.00	12.25	15.81	18.71	22.36		

140° SPRAY ANGLE	MODEL NO.	ORIFICE SIZE (mm)	FLOW CAPACITY IN LPM AT DIFFERENT PRESSURE							G/A DIMENSION. MM		
			SPRAY ANGLE	PRESSURE [BAR]							H	D
				0.5	1.0	2.0	3.0	5.0	7.0	10.0	22	14.8
	CI19.050	0.8	140°	0.25	0.35	0.50	0.61	0.79	0.94	1.12	Weight (Metals) = 32 gms. Approx	
	CI19.075	1.0		0.37	0.53	0.75	0.92	1.19	1.40	1.68		
	CI19.100	1.2		0.50	0.71	1.00	1.22	1.58	1.87	2.24		
	CI19.150	1.5		0.75	1.06	1.50	1.84	2.37	2.81	3.35		
	CI19.175	1.6		0.87	1.24	1.75	2.14	2.77	3.27	3.91		
	CI19.200	1.7		1.00	1.41	2.00	2.45	3.16	3.74	4.47		
	CI19.250	1.9		1.25	1.77	2.50	3.06	3.95	4.68	5.59		
	CI19.300	2.1		1.50	2.12	3.00	3.67	4.74	5.61	6.71		
	CI19.350	2.3		1.75	2.47	3.50	4.29	5.53	6.55	7.83		
	CI19.400	2.4		2.00	2.83	4.00	4.90	6.32	7.48	8.94		
	CI19.475	2.7		2.37	3.36	4.75	5.82	7.51	8.89	10.62		
	CI19.650	3.1		3.25	4.60	6.50	7.96	10.28	12.16	14.53		
	CI19.800	3.5		4.00	5.66	8.00	9.80	12.65	14.97	17.89		
	CI29.100	3.9		5.00	7.07	10.00	12.25	15.81	18.71	22.36		
	CI29.125	4.3	6.25	8.84	12.50	15.31	19.76	23.39	27.95			